

# Drain Waste & Vent (DWV) Systems

SCJ PIPE & FITTINGS FOR NON-PRESSURE SEWERAGE APPLICATIONS

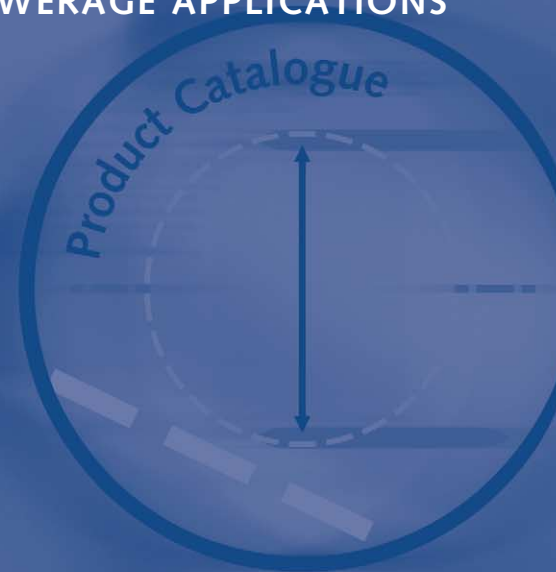



# Drain Waste & Vent (DWV) Systems

## SCJ PIPE & FITTINGS FOR NON-PRESSURE SEWERAGE APPLICATIONS

product manual

### Contents

#### **Introduction**

---

#### **Benefits**

---

#### **The Company**

---

#### **Quality**

---

#### **Australian Standards**

---

#### **Drawings and Dimensions**

---

#### **DWV Sewer Pipe**

---

DWV Sewer Pipe (Heavy)

---

DWV Sewer Pipe (Extra Heavy)

---

#### **DWV Sewer Fittings**

---

Bends

---

Manhold Drop Bends

---

Junctions

---

Tees

---

Access Couplings

---

Threaded Access Caps

---

Couplings

---

Level Invert Tapers

---

Push On Caps

---

Disconnecter Traps

---

Risers

---

Boundary Trap

---

Property Connectors

---

Adaptors

---

Bushes

---

Squash Top Inlets

---

Socket Plugs

---

Flanges

---

Sleeves

---

Vertical Backdrops

---

Saddles

---

#### **Solvent Cement & Priming Fluid**

---

Solvent Cement Type 'P'

---

Solvent Cement Type 'N'

---

Priming Fluid

---

#### **Standard Symbol Guide**

---

Standard SCJ Symbols

---



## Introduction

PVC is widely accepted as the preferred pipe for sewer applications, with advantages of cost effectiveness, long lengths, ease of handling and installation, resistance to root penetration and its proven performance.

The following catalogue details the range of SCJ products manufactured by Vinidex for sewerage applications and included product data for sewer pipe, sewer fittings and appropriate solvent cement and priming fluids.

Vinidex also specialises in fabricated fittings for custom applications. Contact your nearest Vinidex office to discuss customised requirements.

## Benefits

PVC has established itself as the preferred pipe for sewer applications. Authorities and contactors recognize its advantages of cost effectiveness, long length, ease of handling and installation, resistance to root penetration and its proven performance. All PVC Sewerage and Drainage pipes and fittings have similar benefits:

### Corrosion resistance

It's completely immune to corrosion in normal water supply, sewerage and ground-water environments.

### Handling/Installation

The ease of handling, installation and transport provide overall project savings.

### Flexibility

There is flexibility to cope with soil movements, subsidence and expansive clays.

### Superior flow characteristics

It's very smooth bore and chemical resistance characteristics ensure no scale or built up corrosion, thus producing a high flow capacity.

### Easily Machined/Cut

It may be cut and machined with simple tools, ready for jointing, anywhere on the pipe barrel.

## The Company

Vinidex is Australia's leading manufacturer of thermoplastic pipe systems.

Beginning in Sydney in 1960, Vinidex now has nine manufacturing facilities as well as service outlets throughout Australia and is a major national employer.

The Company also has a significant presence in the Asia-Pacific Rim.

Vinidex PVC and polyethylene pipe & fittings systems to 1,000mm diameter are used in a broad cross section of markets which include: Water, Sewerage, Drainage, Plumbing, Mining, Industrial, Irrigation, Gas, Communications, Electrical and Power.

## Quality

Vinidex has achieved Standards Australia StandardsMark Product Certification for a range of PVC and polyethylene pipes. This commitment to product quality is further evidenced by certification as a Quality Endorsed Company to ISO9002.

## Australian Standard

The relevant Australian Standards for Stormwater products include:

AS1254 "Unplasticised PVC (uPVC) pipe and fittings for storm and surface water applications."

AS2439 "Perforated plastics drainage and effluent pipe and fittings."

AS1273 "Unplasticised PVC (uPVC) downpipe and fittings for rainwater."

## Drawings & Dimensions

Drawings and dimensional information are provided as a guide. Fittings are shown as typical configurations and drawings are not to scale. Dimensions may vary marginally and for critical data please contact your local Vinidex office.

# DWV Sewer Pipe SCJ ▶

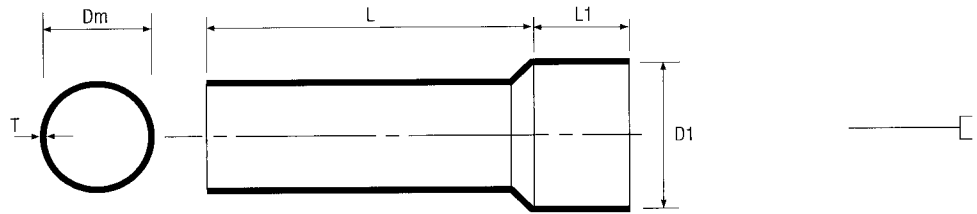

Nom Dia	Code	Length Lo (m)	Qty per pack	Min Wall Thickness Tp (mm)	Socket Depth L (mm)	Spigot Length Lwm (mm)	Average Mass per length (kg)
---------	------	---------------	--------------	----------------------------	---------------------	------------------------	------------------------------

## DWV SEWER SN6 (100mm) SN4 (150mm+) PIPE – SEWER HEAVY

100	19000	6 metres	70	110	3.0	51	10.0
150	19070	6 metres	28	160	4.2	76	20.0
225	19140	6 metres	9	250	6.6	110	50.0
300	19210	6 metres	6 or 8	315	8.4	175	75.0
150	19090	3 metres	28	160	4.2	51	10.0

## DWV SEWER SN8 PIPE – SEWER EXTRA HEAVY

100	19005	6 metres	28	160	5.2	76	25.0
150	19110	6 metres	9	250	8.2	110	60.0
225	19180	6 metres	6 or 8	315	10.4	175	77.0
300	19258	3 metres	28	160	5.2	76	15.0
150	18120	3 metres	6 or 8	315	10.4	175	40.0

\*Effective installed length of 6 metres. Actual pipe length = 6 metres + insertion depth

Nom. size (mm)	Angle	Code	Qty per carton	L1 (mm)	L2 (mm)
----------------	-------	------	----------------	---------	---------

### 15° PLAIN BENDS F&F

100*	15°	46010	50	76	
150*	15°	47000	12	89	
225	15°	47600		200	
300	15°	48000		295	

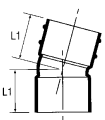

\*Moulded fitting, all other products are custom fabricated.  
Note: All fittings are custom fabricated unless otherwise specified

Nom. size (mm)	Angle	Code	Qty per carton	L1 (mm)	L2 (mm)
-------------------	-------	------	----------------	------------	------------

### 45° PLAIN BENDS F&F

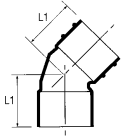

100*	45°	46040	40	84	
150*	45°	47010	12	122	
225*	45°	47410	5	190	
225	45°	47610		235	
300	45°	48010		330	
375	45°	48470		550	

### 90° PLAIN BENDS F&F

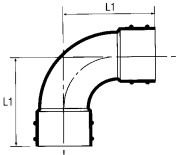

100*	90°	46080	28	165	
150*	88°	47030	8	226	
225*	90°	47420	3	290	
225	90°	47620		375	
300	90°	48020		500	
375	90°	48480		740	

### OTHER PLAIN BENDS F & F

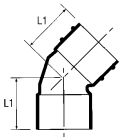

100*	5°	46000	60	60	
100*	30°	46020	45	75	
100*	60°	46070	35	93	
225	30°	47605		230	
225	22.5°	47603		215	
300	60°	48015		395	

### SIDE ACCESS BENDS F & F

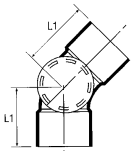

100*	45°	46050	20	116	
100*	88°	46090	15	170	

### REAR ACCESS BENDS

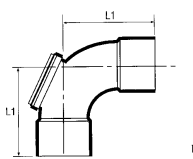

225* F & F	90°	47625		375	
------------	-----	-------	--	-----	--

\*Moulded fitting, all other products are custom fabricated.  
Note: All fittings are custom fabricated unless otherwise specified

# DWV Sewer Pipe SCJ ▶

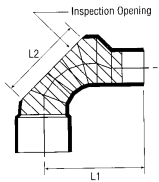

Nom. size (mm)	Angle	Code	Qty per carton	L1 (mm)	L2 (mm)	Type
----------------	-------	------	----------------	---------	---------	------

## 90° MANHOLE DROP BENDS M & F

100	90°	47531		150	110	(MMBW -)
150	90°	47571		220	160	(MMBW -)
225 x 150	90°	47860		450	250	(MMBW -)

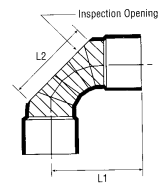

## 90° MANHOLE DROP BENDS F & F

100	90°	47530		160	110	(MMBW -)
150	90°	47570		235	260	(MMBW -)
225	90°	47658		520	495	(MMBW -)

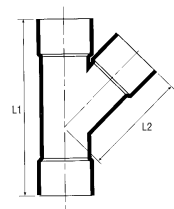

## 45° JUNCTIONS F & F

100*	45°	46200	16	259	190	Threaded Top & Branch
100*	45°	46205	4	277	198	Threaded Top & Branch
150*	45°	47120	4	427	274	Threaded Top & Branch
225*	45°	47450	2	585	440	
225	45°	47680		770	520	
300	45°	48090		960	670	
375	45°	48560		1490	945	
175/100	45°	47586		620	250	(MMBW - 13)
175/150	45°	47587		690	325	(MMBW - 14)

\*Moulded fitting, all other products are custom fabricated.  
Note: All fittings are custom fabricated unless otherwise specified



Nom. size (mm)	Angle	Code	Qty per carton	L1 (mm)	L2 (mm)	Type
-------------------	-------	------	-------------------	------------	------------	------

### 45° REDUCING JUNCTIONS F & F

100 x 65	43°	46220	20	228	167	Threaded - Branch
150 x 100	45°	47110	7	336	263	RRJ Branch
225 x 100	45°	47440	4	480	290	Threaded - Branch
225 x 150	45°	47445	3	480	360	
225 x 100	45°	47660		530	250	
300 x 100	45°	48060		660	400	
300 x 150	45°	48070		760	470	
300 x 225	45°	48080		920	600	
375 x 100	45°	48520		1100	490	
375 x 150	45°	48530		1150	530	
375 x 225	45°	48540		1290	660	
375 x 300	45°	48550		1370	810	

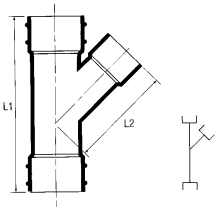

### 90° JUNCTIONS F & F

100*	90°	46300	18	240	145	Threaded - Branch
150*	90°	47205	4	354	204	
225	90°	47740		770	580	
300	90°	48170		960	845	
375	90°	q2746		1490	1069	

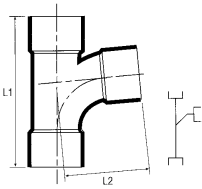

### 90° REDUCING JUNCTIONS F & F

150 x 100	90°	47190	6	300	175	Threaded - Branch
225 x 150	90°	47730				
300 x 225	90°	48160				

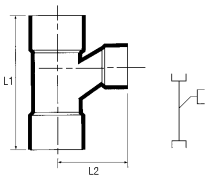

### 45° SIDE ACCESS JUNCTIONS F & F

100	45°	46230	12	277	198	RH
100	45°	46240	12	277	198	LH

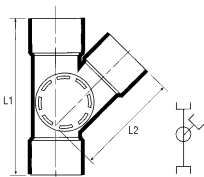

\*Moulded fitting, all other products are custom fabricated.  
Note: All fittings are custom fabricated unless otherwise specified

# DWV Sewer Pipe SCJ ▶

Nom. size (mm)	Angle	Code	Qty per carton	L1 (mm)	L2 (mm)	Type
-------------------	-------	------	-------------------	------------	------------	------

## 90° REAR ACCESS JUNCTIONS F & F

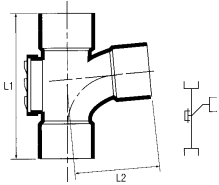

100*	90°	46310	12	240	145	
150	90°	47584		360	204	

## TEE F & F (without cap)

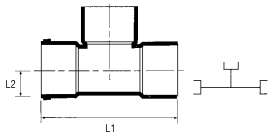

100*		46450	20	220	110	
150*		47290	7	364	162	
225 x 225		47830		660	325	
300 x 300		48250		790	400	

## REDUCING TEE F & F (without cap)

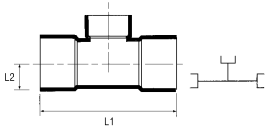

225 x 100		47810		500	230	
225 x 150		47820		545	270	
300 x 150		48230		640	325	

## INSPECTION TEE F & F (includes cap)

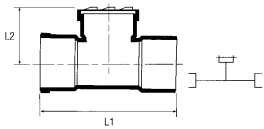

100 x 100*		46440	20	220	120	1 cap
150 x 150*		47280	7	364	162	
225 x 150		47870		545	250	
300 x 150		48300		640	280	

## TEE M & F (without cap)

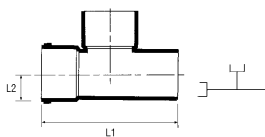

100*		46480	20	220	100	Threaded
150*		47310	7	350	162	

## REDUCING TEE M & F (without cap)

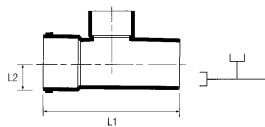

225 x 100		47840		500	250	
-----------	--	-------	--	-----	-----	--

\*Moulded fitting, all other products are custom fabricated.  
Note: All fittings are custom fabricated unless otherwise specified

Nom. size (mm)	Angle	Code	Qty per carton	L1 (mm)	L2 (mm)	Type
----------------	-------	------	----------------	---------	---------	------

### INSPECTION TEE M & F (includes cap)

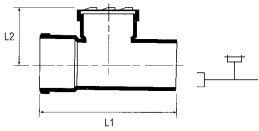

100*		46500	20	220	120	2 caps
100 x 100*		46470	20	219	122	
150 x 150*		47300	7	350	167	
300 x 150		48310		640	280	

### ACCESS COUPLING F & F (without cap)

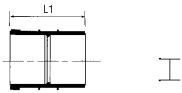

100*		46380	50	107		
150*		47240	18	186		

### ACCESS COUPLING M & F (without cap)

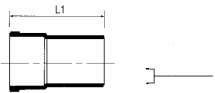

150* (no cap)		47250	18	215		RRJ-Spigot
150* (with cap)		47260	12	250		RRJ-Spigot

### THREADED ACCESS CAP



100*		46430	45	133	31	
150*		47270	40	175	35	

### PUSH ON CAPS

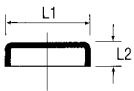

100*		46650	110	114	29	
150*		47380	40	169	42	
225		47990	8	265	175	
300		48450	3	330	220	
375		48990		420	320	

### PLAIN/STRAIGHT COUPLING F & F

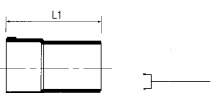

225		47940		320		
300		48390		420		
375		48930		810		

\*Moulded fitting, all other products are custom fabricated.  
Note: All fittings are custom fabricated unless otherwise specified

# DWV Sewer Pipe SCJ ▶

Nom. size (mm)	Angle	Code	Qty per carton	L1 (mm)	L2 (mm)	Type
-------------------	-------	------	-------------------	------------	------------	------

## REPAIR COUPLING F & F

100		58250	35	127	110	
150		58260	12	185	165	

## SLIP COUPLING (RRJ)

100*		50220	35	143		
150*		50520	12	245		

## LEVEL INVERT TAPERS M & F

150 x 100*		47340	20	233		
225 x 100		47900		430		
225 x 150		47910		415		
300 x 225		48350		520		
375 x 225		48870		688		
375 x 300		48880		770		

## DISCONNECTOR TRAP ASSEMBLY (FIXED) F & F

100*		46510	10	447	232	
150		47325	2	460	550	

## 90° D.T. RISER F & F

100 x 50*		46560	36	175	95	
100 x 50 x 50*		46565	20	197	95	

## 90° D.T. 4 – WAY RISER M & F

100 x 50 x 50 x 50 x 40*	46570	20	210	95	
100 x 50 x 50 x 40 x 40*	46575	20	210	95	

## SEWER BOUNDARY TRAP F & F

100*		46510	10	447	232	
------	--	-------	----	-----	-----	--

\*Moulded fitting, all other products are custom fabricated.  
Note: All fittings are custom fabricated unless otherwise specified

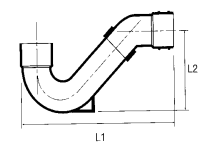
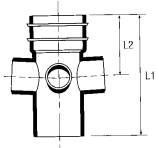
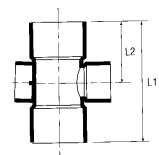
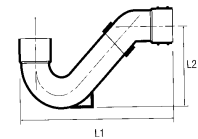
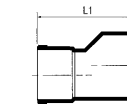
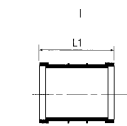
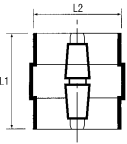

Nom. size (mm)	Angle	Code	Qty per carton	L1 (mm)	L2 (mm)	Type
----------------	-------	------	----------------	---------	---------	------

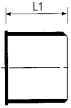

### SOCKET PLUGS

100*		46653	30	110		
150*		47390	12	110		

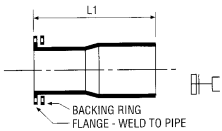

### FLANGES

(Drilled to AS2129 – Table C and includes metal backing ring)

225		47950		220	Socket
300		48400		310	Socket
300		48410		250	Spigot

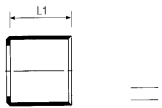

### SLEEVE - PVC SPIGOT TO A.C. SOCKET ADAPTOR

100		47500		90
150		47550		95

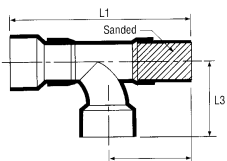

### SEWER VERTICAL BACKDROP

100		47520		
150		47590		

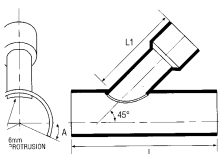

### SEWER SADDLE

150/100	45°	47546		300	315	MMBW - 58
225/100	45°	47775		360	315	MMBW - 59
225/150	45°	47777		420	335	MMBW - 60

\*Moulded fitting, all other products are custom fabricated.  
Note: All fittings are custom fabricated unless otherwise specified

# PVC Downpipe System Solvent Cement Joint

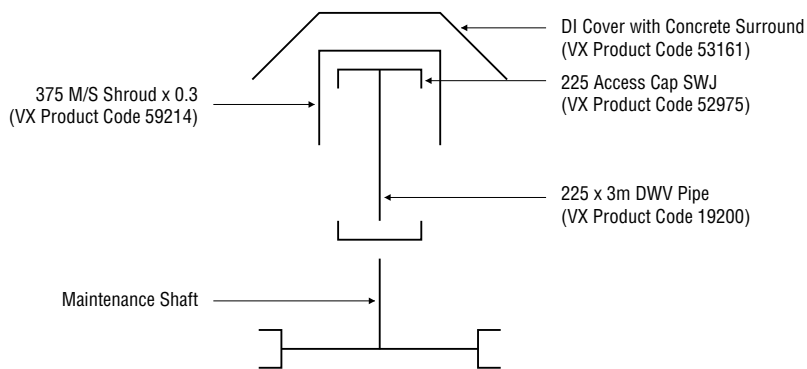

## MAINTENANCE SHAFT

Nom. size (mm)	Code	Description		Hand
150 x 150	52931	In-Line M/S W/Cap SWJ		
225 x 225	52934	In-Line M/S W/Cap SWJ		
150 x 225	52937	In-Line M/S W/Cap SWJ		
150 x 150	52979	Shaft Elbow W/Cap SWJ	15°	Left
150 x 150	52980	Shaft Elbow W/Cap SWJ	15°	Right
150 x 150	52962	Shaft Elbow W/Cap SWJ	22.5°	Left
150 x 150	52963	Shaft Elbow W/Cap SWJ	22.5°	Right
150 x 150	52960	Shaft Elbow W/Cap SWJ	30°	Left
150 x 150	52961	Shaft Elbow W/Cap SWJ	30°	Right
150 x 150	52965	Shaft Elbow W/Cap SWJ	45°	Left
150 x 150	52966	Shaft Elbow W/Cap SWJ	45°	Right
150 x 150	52989	Shaft Elbow W/Cap SWJ	60°	Left
150 x 150	52990	Shaft Elbow W/Cap SWJ	60°	Right
150 x 150	52959	Shaft Elbow W/Cap SWJ	90°	Left
150 x 150	52958	Shaft Elbow W/Cap SWJ	90°	Right
150	52964	Terminal Elbow W/Cap SWJ	90°	
150	65129	Ultra-Rib to PVC Converter		
150	50540	Pipe Socket RRJ		

# PVC Downpipe System Solvent Cement Joint ▶

Code	Size	Qty Per Carton
------	------	-------------------

## PRIMING FLUID - RED

82341	250ml	36
82342	500ml	20
82343	1 litre	12
82344	4 litre	4
82345	20 litre	1

For the use of pressure & non-pressure applications

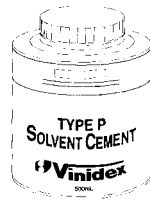

Please note: Clear solvent cements and priming fluid may also be available. Contact your nearest Vinidex office for details. Always use the correct solvent cement for the application.

Average number of joints per 500ml

The following table provides an indication as to the number of joints that are made per 500ml container of priming fluid and solvent cement.

## TYPE 'N' SOLVENT CEMENT - BLUE

82430	125ml	36
82432	250ml	36
82434	500ml	20
82436	1 litre	12
82438	4 litre	4

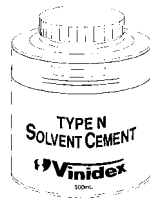

For the use in non-pressure applications

## TYPE 'P' SOLVENT CEMENT - GREEN

82420	125ml	36
82422	250ml	36
82424	500ml	20
82426	1 litre	12
82428	4 litre	4

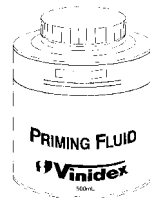











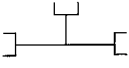
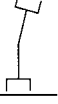
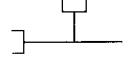
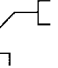

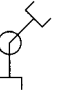
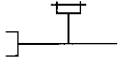
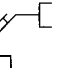
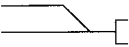
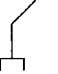
For use in pressure including potable water, applications

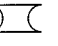
Size of pipe DN (mm)	15	20	25	32	40	50	65	80
Priming Fluid	1050	625	450	325	250	150	125	100
Solvent Cement	300	175	130	95	70	42	35	30

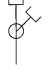
Size of pipe DN (mm)	100	125	150	200	225	250	300	375
Priming Fluid	70	60	45	25	15	12	12	12
Solvent Cement	25	20	15	10	7	6	5	5

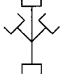
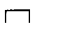
## Standard Symbol Guide

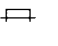
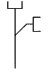
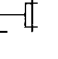
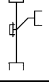
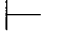
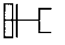
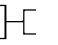
Spigot & Socket – Solvent Weld Joint Pipe (SCJ)		45 o Bend (SCJ)	
Tee (SCJ)		15 o Bend (SCJ)	
Tee, Spigot (SCJ)		90 o Bend (SCJ)	
Inspection Tee, Cap on Branch (SCJ)		Side Access Bend (SCJ)	
Inspection Tee, Spigot, Cap on Branch (SCJ)		90 o Bend, Rear Access (SCJ)	
Level Invert 45°		45 o Bend, Spigot (SCJ)	
Junction (SCJ)		Slip Coupling	
45° Junction, Spigot, (SCJ)		Access Coupling	
45° Junction, Spigot, Side Access (SCJ)		Plain Coupling	
Double Junction – (SCJ)		Push Cap	
90° Junction (SCJ)		Threaded Cap	
90° Junction, Spigot (SCJ)		Connector & Cap	
90° Junction, Rear Access (SCJ)		Socket Plug	
Flange		Adaptor Collar	





**NATIONAL OFFICE**

PO Box 4990  
North Rocks NSW 2151  
TEL: **(02) 9604 2422**  
FAX: **(02) 9604 1078**

**SYDNEY**

254 Woodpark Rd,  
Smithfield NSW 2164  
TEL: **(02) 9604 2422**  
FAX: **(02) 9604 4435**

**MELBOURNE**

86 Whiteside Rd,  
Clayton VIC 3168  
TEL: **(03) 9543 2311**  
FAX: **(03) 9543 7420**

**BRISBANE**

224 Musgrave Rd,  
Coopers Plains QLD 4108  
TEL: **(07) 3277 2822**  
FAX: **(07) 3277 3696**

**TOWNSVILLE**

49 Enterprise Ave,  
Bohle QLD 4816  
TEL: **(07) 4774 5044**  
FAX: **(07) 4774 5728**

**ADELAIDE**

550 Churchill Rd,  
Kilburn SA 5084  
TEL: **(08) 8260 2077**  
FAX: **(08) 8349 6931**

**PERTH**

Sainsbury Rd,  
O'Connor WA 6163  
TEL: **(08) 9337 4344**  
FAX: **(08) 9331 3383**

**DARWIN**

3846 Marjorie St,  
Berrimah NT 0828  
TEL: **(08) 8932 8200**  
FAX: **(08) 8932 8211**

**LAUNCESTON**

15 Thistle St,  
South Launceston TAS 7249  
TEL: **(03) 6344 2521**  
FAX: **(03) 6343 1100**

**HOTLINE 13 11 69**E-mail [info@vinidex.com.au](mailto:info@vinidex.com.au)Website [www.vinidex.com.au](http://www.vinidex.com.au)