

Stormwater Systems

PVC PIPE & FITTINGS, DRAINCOIL PIPE & FITTINGS



Stormwater Systems

PVC PIPE & FITTINGS, DRAINCOIL PIPE & FITTINGS

product catalogue

Contents

Introduction

Stormwater Drainage Pipe

Plain Wall

Stormwater Drainage Fittings

Elbows

Junctions

Tees

Couplings

Reducers

Level Invert Taper

Caps

Saddles

Kerb Adaptors

Flap Valve

Down Pipe Adaptors

Draincoil System

Plain (Unslotted)

Slotted

Slotted With Filtersock

Coupling

Cap

45° Junction

Tee

Reducer F & F

Solvent Cement & Priming Fluid

Priming Fluid

Type 'N' Solvent

Type 'P' Solvent



Introduction

The following catalogue details the range of products manufactured by Vinidex for stormwater drainage applications and includes product data for plain-wall pipes and fittings, and Draincoil pipe and fittings.

Vinidex also specialises in fabricated fittings for custom applications. Contact your nearest Vinidex office to discuss customised requirements.

Benefits

PVC is widely accepted as the preferred pipe for stormwater applications.

Authorities and contractors recognise its advantages of cost effectiveness, long length, ease of handling and installation, resistance to root penetration and its proven performance.

The Company

Vinidex is Australia's leading manufacturer of thermoplastic pipe systems.

Beginning in Sydney in 1960, Vinidex now has six manufacturing facilities as well as service outlets throughout Australia and is a major national employer.

The Company also has a significant presence in the Asia-Pacific Rim.

Vinidex PVC and polyethylene pipe & fittings systems of 1,000mm diameter are used in a broad cross section of markets which include:

Water, Sewerage, Drainage, Plumbing, Mining, Industrial, Irrigation, Gas, Communications, Electrical and Power.

Quality

Vinidex has achieved Standards Australia StandardsMark Product Certification for a range of PVC and polyethylene pipes. This commitment to product quality is further evidenced by certification as a Quality Endorsed Company to ISO9001.

Australian Standard

The relevant Australian Standards for Stormwater products include:

AS1254 "Unplasticised PVC (uPVC) pipe and fittings for storm and surface water applications."

AS2439 "Perforated plastics drainage and effluent pipe and fittings."

AS1273 "Unplasticised PVC (uPVC) downpipe and fittings for rainwater."

Drawings & Dimensions

Drawings and dimensional information are provided as a guide. Fittings are shown as typical configurations and drawings are not to scale. Dimensions may vary marginally and for critical data please contact your local Vinidex office.

Stormwater Drainage Pipe Plain Wall ▶

STORMWATER DRAINAGE PIPE - PLAIN WALL

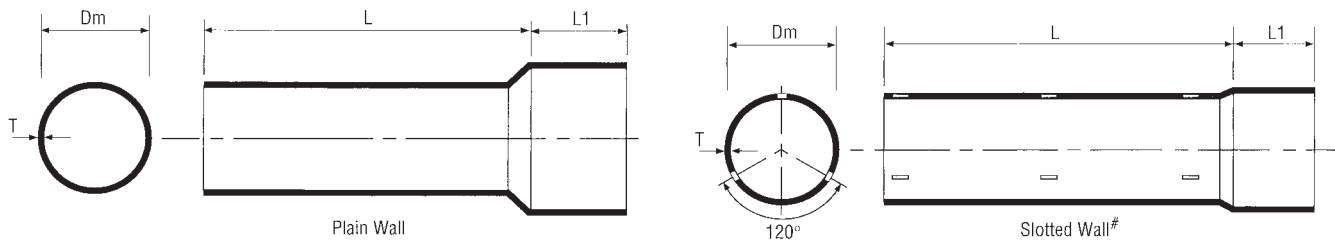

Nom Dia (mm)	Code	Length \varnothing L (m)	Qty per pack	Mean OD Dm (mm)	Mean Wall Thickness T (mm)	Socket Depth L1 (mm)	Average Mass per length (kg)
--------------	------	----------------------------	--------------	-----------------	----------------------------	----------------------	------------------------------

STORMWATER DRAINAGE PIPE – SCJ

90	20510	6	72	90.2	1.8	65	5
90 SEH	20512	6	72	90.2	2.0	65	6
100	20520	6	70	110.2	2.2	65	9
150	20530	6	26	160.3	2.9	90	14
225	20540	6	12	250.4	4.5	130	33
300	20550	6	6 or 8	315.5	5.7	175	53
375	20580	6	6	315.5	5.7		87
375 RRJ	20590	6	6	400.5	7.2	200	87

STORMWATER DRAINAGE PIPE – SCJ Slotted Wall (Extra Heavy) AS1254

90	20670	6	72	90.2	1.8	65	5
150	20710	6	26	160.3	2.9	90	14

*Other sizes available upon request. Please contact your local VX Sales office for lead times.

Slot dimensions: 3 rows 100mm x 4mm x 300mm centres.
 \varnothing Effective installed length of 6 metres. Actual pipe length = L + insertion depth.

Stormwater Drainage Fittings Solvent Cement Joint



Nom. size (mm)	Angle	Code	Carton Qty	Min. Oder Qty	L (mm)	Type
-------------------	-------	------	---------------	------------------	-----------	------

45° ELBOWS F& F

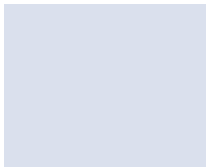
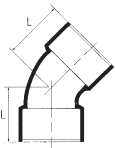

90	45°	60320	60	60	55	
100 [^]	45°	46040	28	28	75	
150	45°	60330	10	5	120	
225	45°	47410	5	1	235	Ribbed
300*	45°	60940		1	330	
375* [^]	45°	48470		1	550	

90° ELBOWS F& F

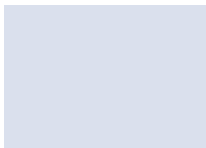

90	90°	60360	55	55	65	
100 [^]	90°	46080	20	20	110	
150	90°	60370	9	9	135	
225 [^]	90°	47420	3	3	375	Ribbed
300*	90°	60970		1	500	
375* [^]	90°	48480		1	740	

15° ELBOWS F& F

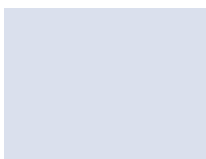

90	15°	60450	80	20	42	
100 [^]	15°	46010	27	27	70	
150 [^]	15°	47000	12	6	125	
225*	15°	60900		1	200	
300*	15°	60910		1	295	

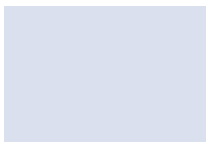
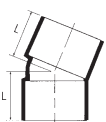

22.5° ELBOWS F& F

90	22.5°	60480	80	20	55	
300*	22.5°	q3402		1	315	

* Fabricated fitting
[^] Sewer product

Stormwater Drainage Fittings Solvent Cement Joint



Nom. size (mm)	Angle	Code	Carton Qty	Min. Order Qty	L (mm)	Type
----------------	-------	------	------------	----------------	--------	------

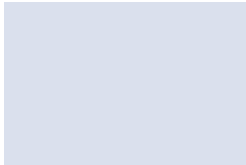
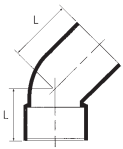

45° ELBOWS M & F

90	45°	60010	70	20	55	
100 [^]	45°	46150	28	28	80	
150 [^]	45°	47060	5	5	120	

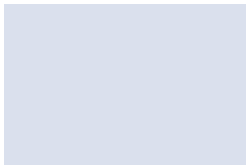
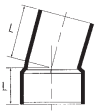

90° ELBOWS M & F

100 [^]	90°	46170	15	5	110	
150 [^]	90°	47090	6	6	165	
225 ^{*^}	90°	47650		1	375	

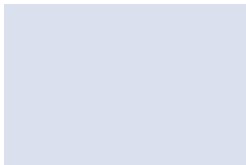
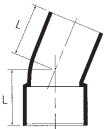

15° ELBOWS M & F

90	15°	60390	20	20	42	
100 [^]	15°	46130	25	5	72	
150 [^]	15°	47050	15	5	120	

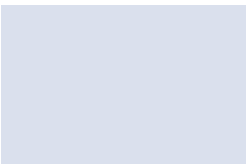

22.5° ELBOWS M & F

90	22.5°	60420	80	20	42	
----	-------	-------	----	----	----	--

* Fabricated fitting
^ Sewer product

Stormwater Drainage Fittings Solvent Cement Joint ▶

Nom. size (mm)	Angle	Code	Carton Qty	Min. order Qty	L (mm)	L1 (mm)	Type
----------------	-------	------	------------	----------------	--------	---------	------

45° SLOPE JUNCTION F & F

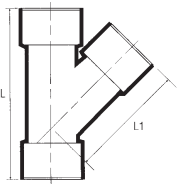

90	45°	60050	30	30	192	120	
100 [^]	45°	46200	13	13	259	190	Threaded
150	45°	60065	4	4	358	258	
225	45°	60565	2	1	770	520	Ribbed
300*	45°	60578		1	950	670	

45° REDUCING SLOPE JUNCTION F & F

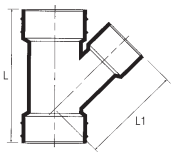

150x100	45°	60060	5	5	358	225	
225x100 [^]	45°	47440	4	4	530	340	Ribbed
225x150 [^]	45°	47445	3	3	620	440	Ribbed
300x150*	45°	60574		1	760	470	
300x225*	45°	60576		1	920	600	
375x100* [^]	45°	48520		1	1100	490	
375x150* [^]	45°	48530		1	1150	530	

TEES F & F



90	90°	60100	30	30	160	85	Threaded
100 [^]	90°	46440	16	16	240	120	With cap
150	90°	60110	6	6	290	150	Threaded
225*	90°	60620		1	660	325	
300*	90°	60628		1	800	400	

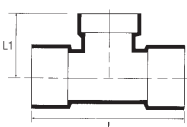

REDUCING TEES F & F

225x150*	90°	60610		1	545	270	
300x150*	90°	48230		1	650	325	

* Fabricated fitting
[^] Sewer product

Stormwater Drainage Fittings Solvent Cement Joint

Nom. size (mm)	Code	Carton Qty	Min. Oder Qty	L (mm)	Type
-------------------	------	---------------	------------------	-----------	------

COUPLINGS F & F

90	60150	100	20	65	Threaded
90	60160	70	10	100	Slip
100 [^]	46380	40	10	112	
150	60153	18	6	130	
225* [^]	47940		1	300	
300*	60650		1	420	
375* [^]	48930		1	810	



REDUCING COUPLINGS F & F

110 x 90*	60660	60	1	180	
-----------	-------	----	---	-----	--



REDUCING COUPLINGS M & F

150 x 90*	60690		1	340	
-----------	-------	--	---	-----	--

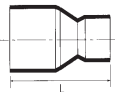

Nom. size (mm)	Code	Carton Qty	Min Order Qty	L (mm)
-------------------	------	---------------	------------------	-----------

MULTI-REDUCER

90 x 75 x 65 x 50 x 40	60190	80	10	110
------------------------	-------	----	----	-----



SOCKET REDUCER (BUSH)

100 x 90	60200	70	10	50
150 x 100	60210	25	5	65



Stormwater Drainage Fittings Solvent Cement Joint

Nom. size (mm)	Angle	Code	Carton Qty	Min. Order Qty	L (mm)	L1 (mm)	Type
----------------	-------	------	------------	----------------	--------	---------	------

LEVEL INVERT TAPER M & F

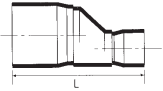

150 x 100 [^]		47340	10	2	235		
225 x 150*		61125		1	430		
300 x 225*		61135		1	520		

CAPS (PUSH ON)



90		60240	160	20	32		
100 [^]		46650	26	26	28		
150		60248	45	5	96		2 -Way
225* [^]		47990	21	1	150		
300* [^]		48450	3	1	220		
375* [^]		48990		1	390		

CAPS (THREADED ACCESS)

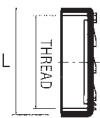

90		60250	90	10	115		
100 [^]		46430	40	10	173		
150 [^]		47270	40	10	173		

45° SADDLES (SOCKET BRANCH)

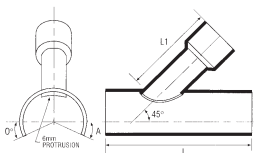

150 x 100*		61304		1	250	260	
225 x 100*		61312	5	1	350	260	
225 x 150*		61316	3	1	420	335	
375 x 150*		61338		1	550	360	

* Fabricated fitting
[^] Sewer product

Stormwater Drainage Fittings Solvent Cement Joint ▶

Nom. size (mm)	Angle	Code	Carton Qty	Min. Order Qty	L (mm)	L1 (mm)	Type
-------------------	-------	------	---------------	-------------------	-----------	------------	------

90° SADDLES (SOCKET BRANCH)

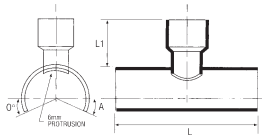

150 x 100*		61302		1	250	80	
225 x 100*		61314	5	1	250	80	
225 x 150*		61318	3	1	300	120	
300 x 100*		61326	3	1	250	80	
300 x 150*		61330		1	300	120	

KERB ADAPTOR SOCKET

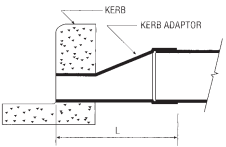

140 x 40 x 100*		60860	15	1	400		
125 x 50 x 100*		60870	20	1	400		
150 x 55 x 100*		60872	25	1	400		
100 x 50 x 100*		60875	22	1	400		

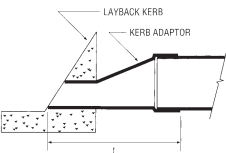

LAYBACK KERB ADAPTOR

100 x 50 x 90*		60878	25	1	400		
125 x 50 x 100*		60883	26	1	400		

FLAP VALVE

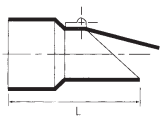

90		61220		1	150		
100*^		57364	21	1	150		
150*^		57368	12	1	200		
225*†		57369		1	300		
375*†		57349		1	700		

* Fabricated fitting
^ Sewer product
† SWV product

Stormwater Drainage Systems Solvent Cement Joint ▶

Nom. size (mm)	Angle	Code	Length	Carton Qty	Min. Order Qty	L (mm)
-------------------	-------	------	--------	---------------	-------------------	-----------

DOWNPIPE ADAPTORS M & F (RECTANGULAR)

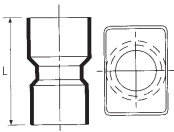

100 x 80 x 100*		60820		45	1	180
100 x 100 x 100*		60835		35	35	200
150 x 100 x 100*		60853		5	1	460
150 x 150 x 100*		60855			1	540
150 x 150 x 150*		60857		6	1	220

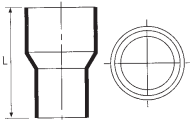

DOWNPIPE ADAPTORS F & F (RECTANGULAR)

100 x 80 x 90*		60290		70	10	180
100 x 100 x 100*		60830		35	35	200

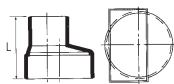

CAT 36 DOWNPIPE ADAPTORS F & F (RECTANGULAR)

100 x 50 x 90		60280		80	20	105	Offset
---------------	--	-------	--	----	----	-----	--------

Draincoil System ▶

Nom. size (mm)	Coil size (meters)	Code	Class
-------------------	-----------------------	------	-------

PLAIN – (UNSLOTTED)

65	20	24603	400
----	----	-------	-----

SLOTTED

65	20	24600	400
----	----	-------	-----

Nom. size (mm)	Coil size (meters)	Code	Class
-------------------	-----------------------	------	-------

SLOTTED-WITH FILTERSOCK

65	20	24608	400
100	20	24703	400
100	100	24712	400
>100	100	24725	1000

Filtersock is fitted to coil

> PVC white – all class 200 & 400 polyethylene.
For slot specification data refer to AS2439 Part 1.

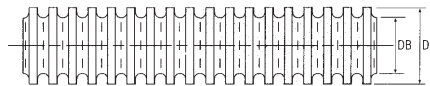
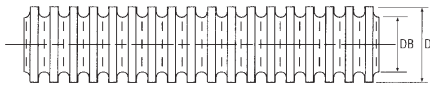
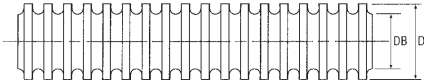

Nom. size (mm)	Code	Carton Qty	Min. Order Qty	L (mm)	L1 (mm)	Type
----------------	------	------------	----------------	--------	---------	------

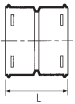

COUPLING

100	65560	80	1	95		
-----	-------	----	---	----	--	--



CAP

100	65570	170	1	50		
-----	-------	-----	---	----	--	--

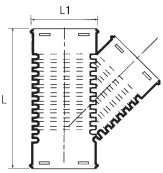

45° JUNCTION

100*	65580	16	1	235	170	
------	-------	----	---	-----	-----	--

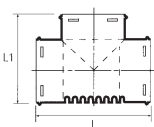

TEE

100	65600	25	1	195	150	
-----	-------	----	---	-----	-----	--

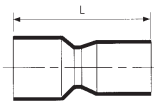

REDUCER F & F

100x90*	65740	70	1	125		
---------	-------	----	---	-----	--	--

*Fabricated fitting

Solvent Cement & Priming Fluid - AS3879 ▶

Code	Size	Qty Per Carton
------	------	----------------

PRIMING FLUID - RED

82341	250ml	36
82342	500ml	20
82343	1 litre	12
82344	4 litre	4
82345	20 litre	1

For the use of pressure & non-pressure applications

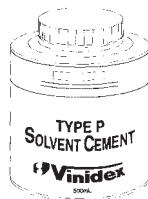

Please note: Clear solvent cements and priming fluid may also be available. Contact your nearest Vinidex office for details. Always use the correct solvent cement for the application.

Average number of joints per 500ml

The following table provides an indication as to the number of joints that are made per 500ml container of priming fluid and solvent cement.

TYPE 'N' SOLVENT CEMENT - BLUE

82430	125ml	36
82432	250ml	36
82434	500ml	20
82436	1 litre	12
82438	4 litre	4

For the use in non-pressure applications

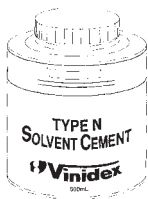

TYPE 'P' SOLVENT CEMENT - GREEN

82420	125ml	36
82422	250ml	36
82424	500ml	20
82426	1 litre	12
82428	4 litre	4

For use in pressure including potable water applications

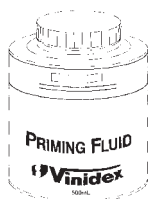

Solvent Cement & Priming Fluid - AS3879 ▶

Size of pipe DN (mm)	15	20	25	32	40	50	65	80
Priming Fluid	1050	625	450	325	250	150	125	100
Solvent Cement	300	175	130	95	70	42	35	30

Size of pipe DN (mm)	100	125	150	200	225	250	300	375
Priming Fluid	70	60	45	25	15	12	12	12
Solvent Cement	25	20	15	10	7	6	5	5



NATIONAL OFFICE

19-21 Loyalty Road
North Rocks NSW 2151
TEL: (02) 8839 9006
FAX: (02) 8839 9152

NEW SOUTH WALES

254 Woodpark Rd,
Smithfield NSW 2164
TEL: (02) 9604 2422
FAX: (02) 9604 4435

101 Brynes Rd
North Wagga Wagga NSW 2164
TEL: (02) 9671 9312
FAX: (02) 9671 9286

VICTORIA

Unit 1/10 Duerdin St
Notting Hill 3168
TEL: (03) 9543 2311
FAX: (03) 9543 7420

231 - 245 St. Albans Rd
Sunshine VIC 3020
TEL: (03) 9543 2311
FAX: (03) 9311 6230

QUEENSLAND

224 Musgrave Rd,
Coopers Plains QLD 4108
TEL: (07) 3277 2822
FAX: (07) 3277 3696

49 Enterprise Ave,
Bohle QLD 4816
TEL: (07) 4774 5044
FAX: (07) 4774 5728

SOUTH AUSTRALIA

9-1 Kaurna Ave
Edinburgh SA 5111
TEL: (03) 9543 2311
FAX: (08) 8250 1625

WESTERN AUSTRALIA

Sainsbury Rd,
O'Connor WA 6163
TEL: (08) 9337 4344
FAX: (08) 9331 3383

DARWIN

3846 Marjorie St,
Pinelands NT 0828
TEL: (08) 8932 8200
FAX: (08) 8932 8211

TASMANIA

15 Thistle St,
South Launceston TAS 7249
TEL: (03) 6344 2521
FAX: (03) 6343 1100

HOTLINE 13 11 69

E-mail info@vinidex.com.au

Website www.vinidex.com.au